

The Early Freedman Communities

This map shows early freedmen communities that were formed in Travis County immediately after the Civil War. Urban areas were convenient for people who worked in the city. Rural communities contained families who were engaged in farming.

Using a copy of this 1891 Austin Map as a base map, 9 of the 12 communities are shown in the shaded areas. The boundaries for these communities are based on documentary evidence available to the AHC. Communities not shown are indicated in the gray box below.

P. C. TAYLOR,
Banking and Exchange Office
122 Congress Ave., Austin, Texas.

BOOTH & McLEAN,
Land, Loan and Investment Brokers,
122 Congress Ave., Austin, Texas.

R. M. HALL,
Land and General Agent,
Office West 7th Street,
Austin, Texas.

SIDON HARRIS,
Attorney and Counsellor at Law,
TEMPORARY CAPITOL BUILDING,
AUSTIN, TEXAS.

CALCASIEU LUMBER CO.,
Lumber, Laths, Shingles, Sash, Doors,
KINDS, BUILDERS HARDWARE,
OFFICE AND YARDS,
On Live Oak and Chastain Sts.,
AUSTIN, TEXAS.

ARLITT & LACY,
Roofing, Cutting,
Water Piping,
GENERAL JOB WORK,
308 East 6th Street,
AUSTIN, TEXAS.

DORHARDT & BRUCKMANN,
CIGARS,
1005 Congress Avenue,
AUSTIN, TEXAS.

First National Bank of Austin,
Capital \$100,000,
Authorized Capital \$500,000,
Austin, Texas.

G. R. FURR & CO.,
REAL ESTATE,
AND
INVESTMENT BANKERS,
1005 Congress Avenue,
AUSTIN, TEXAS.

THOMSON & DONNAN,
GENERAL LAND
AND
CLAIM AGENTS,
Austin, Texas.

WALTON & CALHOUN,
ATTORNEYS AT LAW,
AUSTIN, TEXAS.

WALSH & ALLEN,
General Land & Insurance
AGENTS,
Austin, Texas.

McCLEERY & MORRIS,
REAL ESTATE,
Insurance and Loans,
808 CONGRESS AVE.,
AUSTIN, TEXAS.

THE H. J. HAZZARD CO.,
PIANOS, ORGANS, SHT MUSIC, MUSICAL INSTRUMENTS,
PIANOS!
W. PHULEMEYER,
Real Estate Dealer,
Austin, Texas.

CHAS. A. NEWNUNG,
General Land and Insurance
AGENTS,
Austin, Texas.

Real Estate, Investment AND Loan Agents.
CLEVELAND & LOTT,
623 Congress Avenue,
AUSTIN, TEXAS.

EGGLESTON & GOLDBECK,
BROKERS,
Land and Collecting Agents,
Negotiating Loans a Specialty,
Post Office Box No. 74,
AUSTIN, TEXAS.

A. Wyszczek & Co.,
LAND AND General Agents,
Temporary Offices,
AUSTIN, TEXAS.

The Austin Real Estate ABSTRACT CO.,
A Complete Abstract of Land Titles in City of Austin and Travis County,
Austin City Property a Specialty,
Austin, Texas.

WARNER AND RAYMOND,
Real Estate,
AUSTIN, TEXAS.

BERGEN, DANIEL & GRACY,
Land, Insurance and Finance AGENTS,
Proprietors of Abstract of Titles
Real Estate and Insurance Agents in Travis County,
Austin, Texas.

Covert & McCarty,
Real Estate, Insurance AND GENERAL AGENTS,
712 Congress Avenue,
AUSTIN, TEXAS.

HOLLAND, BROWN & WALKER,
LAND AND REAL ESTATE,
111 W. 7th Street, AUSTIN, TEXAS.

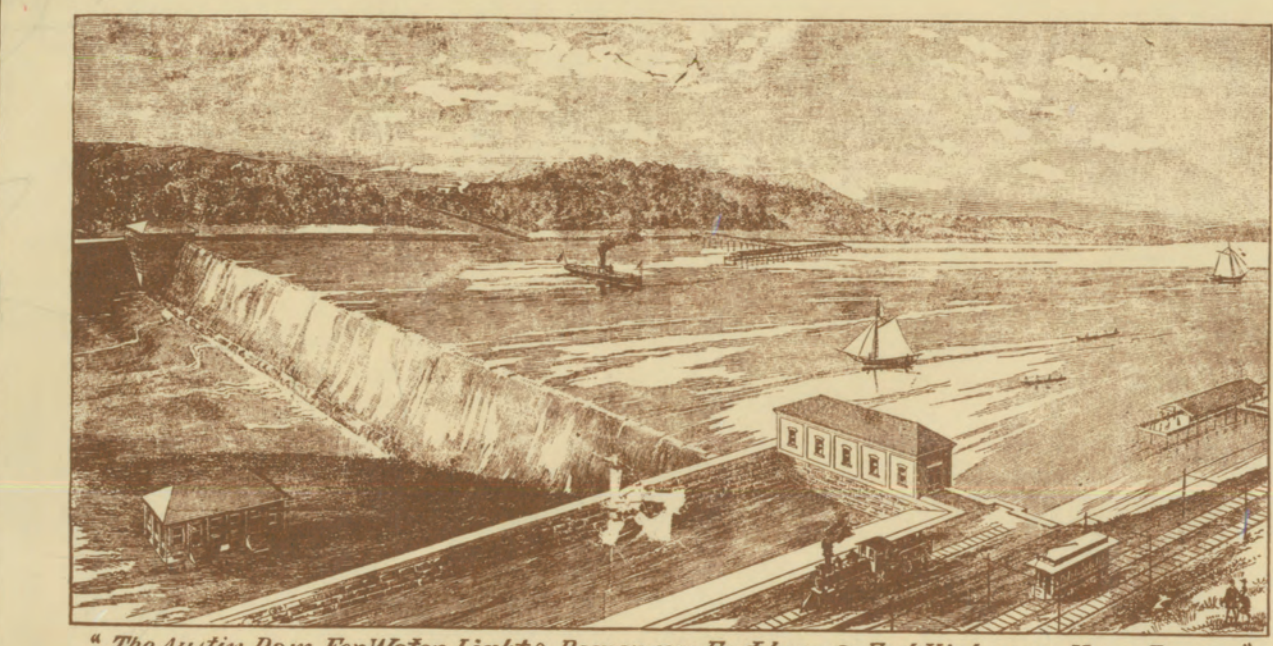

The Austin Down, the Water Light, Power and Fuel Long on Red Hill, from Texas River

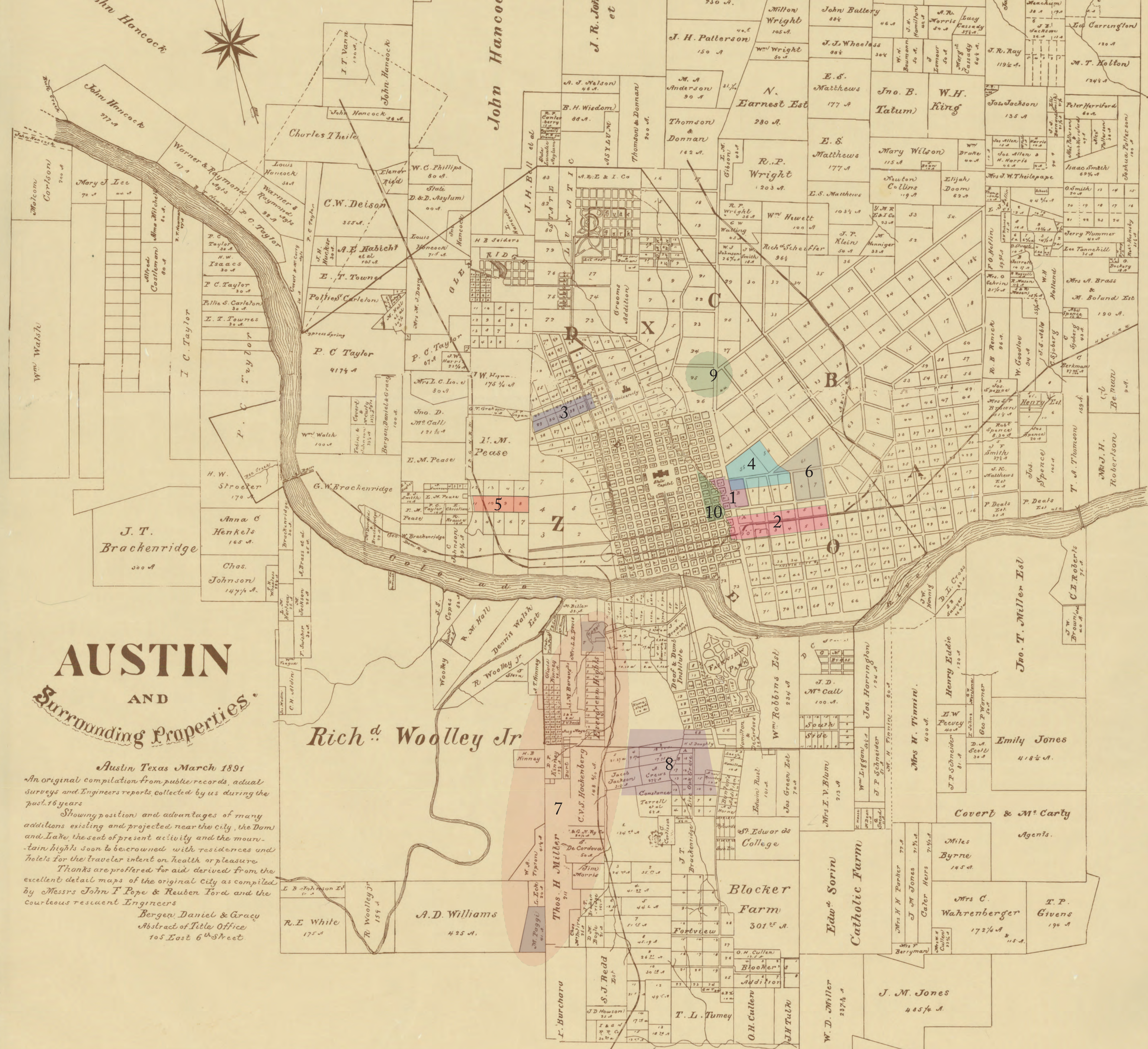

AUSTIN AND Surrounding Properties.
Austin Texas March 1891
An original compilation from public records, actual surveys and Engineer reports collected by us during the past 18 years.
Showing positions and advantages of many available building and property near the city, the town and lake, the best of present activity and the means of the future, with residence and hotels for the traveler, school, health, or pleasure. Think of the profit for real estate from the excellent detail maps of the original city as compiled by Messrs. John T. Pope & Rowden Ford, and the excellent recent Engineers Bergon, Daniel & Gracy, Sub-agent of Title Office, 101 East 6th Street.

THE H. J. HAZZARD CO.,
PIANOS, ORGANS, SHT MUSIC, MUSICAL INSTRUMENTS,
PIANOS!
W. PHULEMEYER,
Real Estate Dealer,
Austin, Texas.

Safe Investors Will Buy Lots in FAIRVIEW PARK,
IN THE TOWN OF SOUTH AUSTIN, TEXAS,
ONE MILE FROM CENTER
L. M. ODOM & CO.,
General Land and Insurance AGENTS,
Austin, Texas.

West Union Protective & Detective ASSOCIATION,
111 W. 7th Street, Austin, Texas.

Bergen, Daniel, Gracy
Map of Austin & Surrounding Properties
Bergen, Daniel, Gracy, 1891
Map # L-23

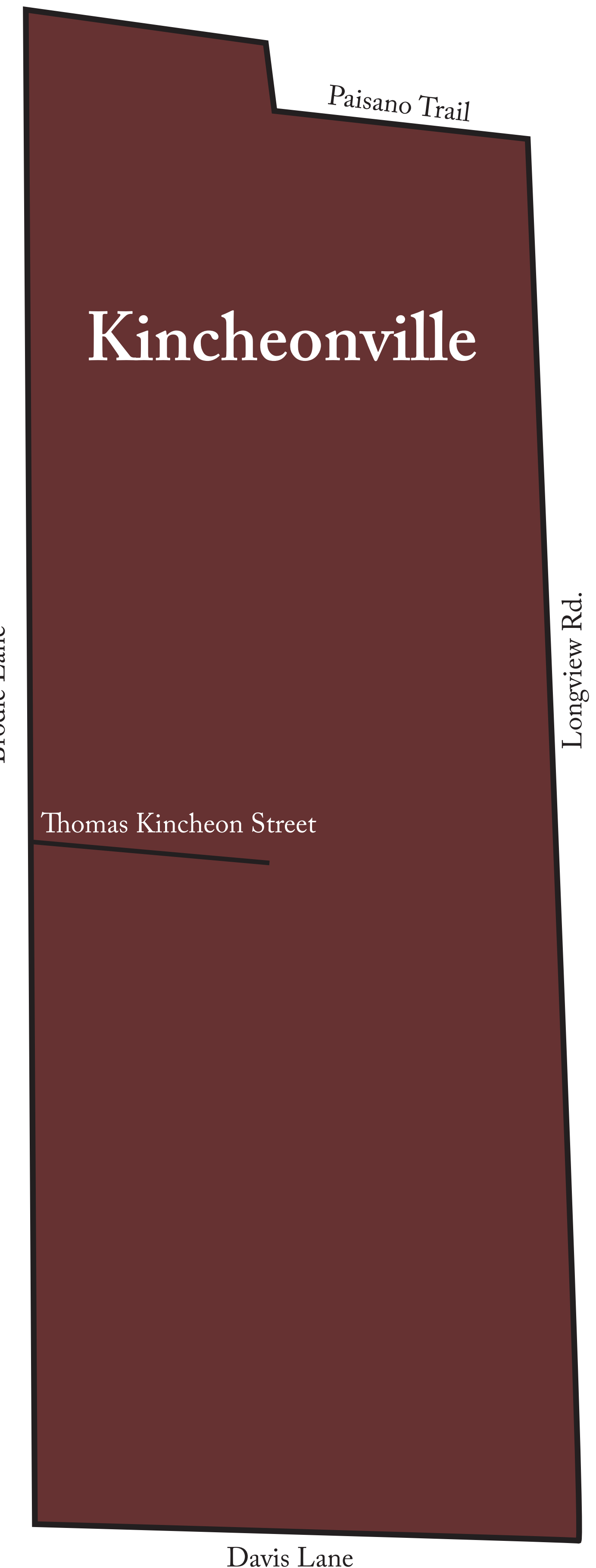

Thomas Kincheon began farming this area immediately after the Civil War. The area was not only home to freed slaves, but also Mexican and white farmers. According to the article on Kincheonville in *The Handbook of Texas*, all that remains of Kincheonville are a few streets named after members of his family, including one named for him. Streets with personal names like Elija, Minnie and Blumie, names of very minor places associated with the Union during the Civil War, such as Clarksburg and Galesburg, and the name of one major event at Harper's Ferry quietly mark the history of this area.

Communities not indicated on map:
Burditt's Prairie (the Burditt Plantation)
East Austin at Felix Ave. and Valdez St. on the east, Felix and Vasquez St. on the Northeast. Burditt's Prairie Cemetery is to the north of Felix Ave.
Ryna Branch
In or near Bluff Springs (exact location not known).
Bell Hill
Off Bee Caves Road near Jackson Cemetery (exact location not known).

1. Pleasant Hill - East of Waller Creek, west of San Marcos St., with E. 11th St. on the north and E. 7th St to the south.
2. Mason Town - East of Waller Creek between E. 3rd on the north, E. 6th to the south and Chicon St. on the east.
3. Wheatville - East bank of Shoal Creek between W. 24 St. and W. 26 St. with Rio Grande St. on the east.
4. Robertson Hill - On the bluff north and west of the French Legation, north of Pleasant Hill area and east of Waller Creek. Also, between E. 10th and E. 14th with East Ave. (I-35) on the west and Navasota St. to the east.
5. Clarksville - Early boundaries were Waterston St. to the north, W. 10th to the south, W. Lynn St. on the east and Johnson Creek on the west.
6. Gregory Town - Chincapin or Rosewood to the north, Rector and Comal to the west, E. 7th to the south, and Chicon on the east.
7. Barton Springs area - extending from near the Paggi House (the old Goodrich Plantation) on Lee Barton to the south near Oltorf between Goodrich and Kinney. Information on the precise boundaries is unclear.
8. Southside - Eva and S. 1st streets on the east to S. 5th on the west. Southern boundary near Oltorf St. with the northern boundary on Monroe St.
9. Horst's Pasture (Horst Plantation) - East Ave. between 23rd and 24th streets. Exact boundaries unknown.
10. Red River Street Community (no official name known, Michelle Mears named the area in her thesis *African American Settlement Patterns in Austin, Texas, 1865-1928*) - West of Waller Creek between E. 6th on the south, E. 13th to the north and Neches St. on the east. Exact boundaries are unknown.